

* DIMENSIONS MAY BE ADAPTIVE IN ACTUAL FABRICATION

- (0) 100A PANEL w/15A CT.
- (1) CARD ACCESS PANEL
- (2) CARD READER (6 TYP)
- (3) COOKSON STEEL DOOR (6 TYP)
- (4) DOOR END OF CONTAINER (LOCKED)
- (5) FLUORESCENT LIGHT FIXTURES (6 TYP)
- (6) FULL HEIGHT BARRIER (2 TYP)
- (7) TURNSTILE MPT33C (3 TYP)
(PRISON GRADE 2-WAY ELECTRIC)

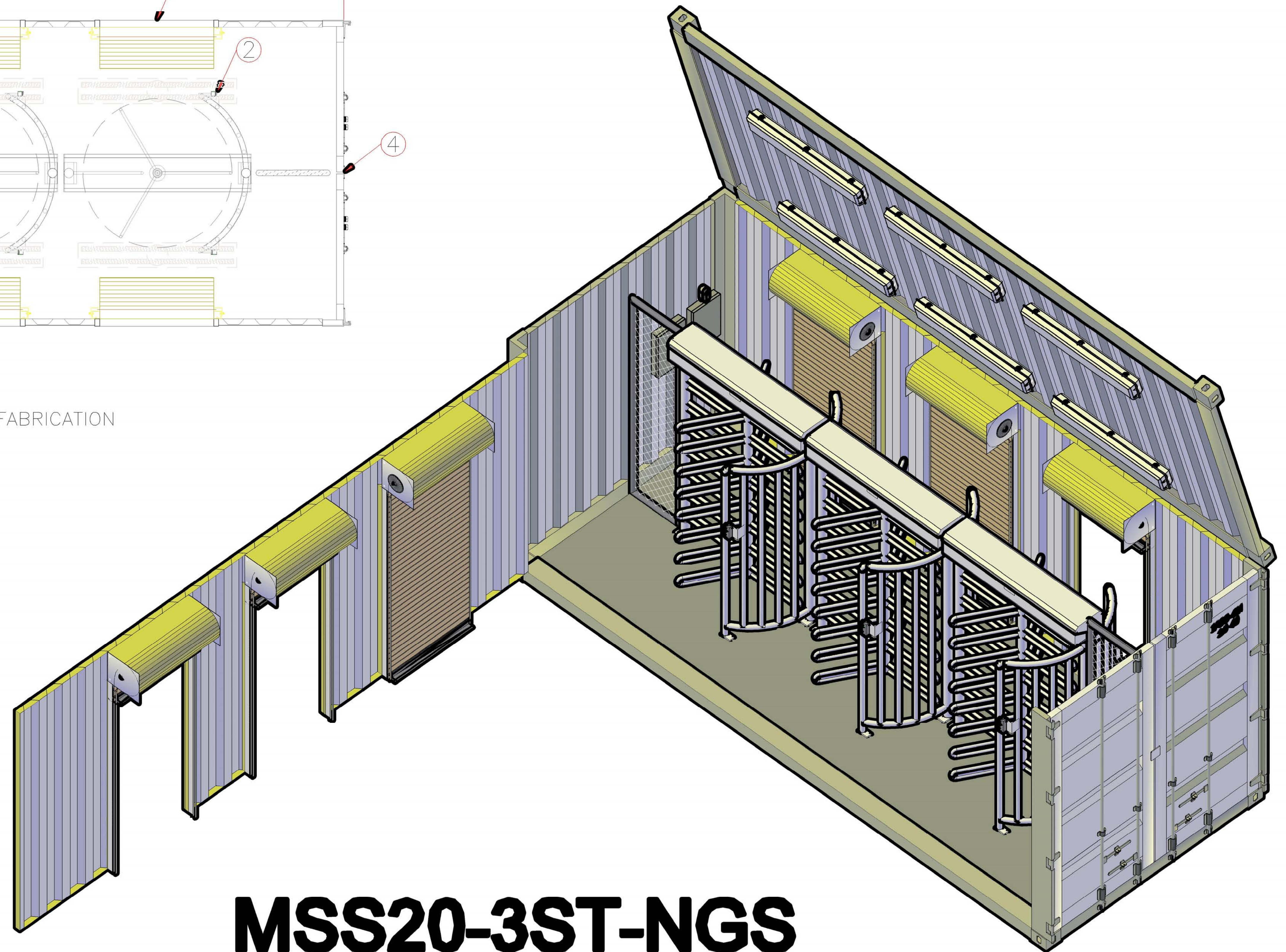

MSS20-3ST-NGS